

LAGERHUS LAAKERIPESÄT LEJEHUS

Kompletta stålagerhus Teräksiset pesälaakeriyksiköt Komplette stålejerhus

NP.....	71-72
SNP	71-72
UCP	71-72
UCPA.....	71-72
UP, lätt serie kevyt sarja let serie....	71-72

Lagerhus i gjutjärn Valurautapesät Lejehuse i støbejern

SNT	74-75
SNTD.....	76

Kompletta flänslagerhus Laippalliset pesälaakeriyksiköt Komplette flangelejerhuse

SF.....	77-78
SFT.....	77-78
UCF	77-78
UCFL	77-78

Insatslager Laakeriyksiköt Indsatslejer

.....	79
-------	----

Stålagerhus | Laakeripesät | Stålejhuse

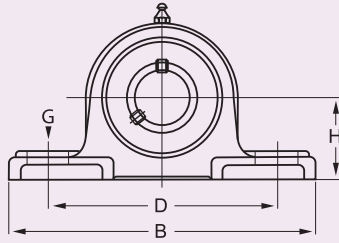

UCP/NP

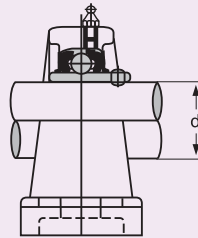

UCP

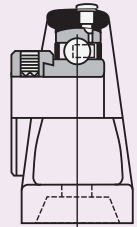

NP-EC

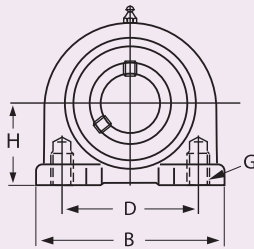

UCPA/SNP

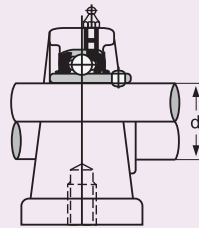

UCPA

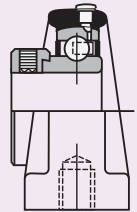

SNP-EC

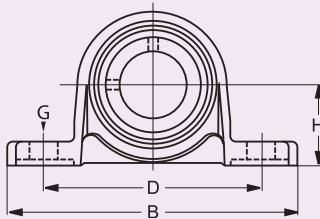

UP

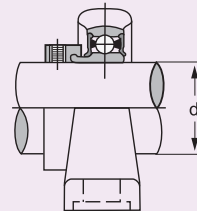

UP

Stålagerhus | Laakeripesät | Stålejhuse

d 10-90 mm.

Beteckning Nimike Betegnelse	mm				Skruv Ruuvi Skruue G
	d	H	B	D	
	UP 000	10	18	67	
NP 12	12	30	126,5	95	10
NP 12 EC	12	30	126,5	95	10
UCP 201	12	30	127	95	10
UCPA 201	12	30	76	52	10
UP 001	12	19	71	56	6
NP 15	15	30	126,5	95	10
NP 15 EC	15	30	126,5	95	10
UCP 202	15	30	127	95	10
UCPA 202	15	30	76	52	10
UP 002	15	22	80	63	6
NP 17	17	30	126,5	95	10
NP 17 EC	17	30	126,5	95	10
UCP 203	17	30	127	95	10
UCPA 203	17	30	76	52	10
UP 003	17	24	85	67	6
NP 20	20	33	127	95	10
NP 20 EC	20	33	127	95	10
SNP 20 EC	20	33	75	50,8	8x1,25
UCP 204	20	33	127	95	10
UCPA 204	20	30	76	52	10
UP 004	20	28	100	80	8
NP 25	25	37	139	105	10
NP 25 EC	25	37	139	105	10
SNP 25 EC	25	37	80	50,8	10x1,50
UCP 205	25	37	140	105	10
UCPA 205	25	36	84	56	10
UP 005	25	32	112	90	8
NP 30	30	43	160,5	121	12
NP 30 EC	30	43	160,5	121	12
SNP 30 EC	30	43	96	76,2	10x1,50
UCP 206	30	43	165	121	14
UCPA 206	30	42	94	66	14
UP 006	30	36	132	106	10
NP 35	35	48	166	127	12
NP 35 EC	35	48	166	127	12
SNP 35 EC	35	48	110	82,6	10x1,50
UCP 207	35	48	167	127	14
UCPA 207	35	47	110	80	14
NP 40	40	49	180,5	137	12
NP 40 EC	40	49	180,5	137	12
SNP 40 EC	40	49	118	88,9	12x1,75
UCP 208	40	49	184	137	14
UCPA 208	40	49	116	84	14

Beteckning Nimike Betegnelse	mm				Skruv Ruuvi Skruue G
	d	H	B	D	
	NP 45	45	54	190,5	
NP 45 EC	45	54	190,5	146	12
SNP 45 EC	45	54	127	95,3	12x1,75
UCP 209	45	54	190	146	14
UCPA 209	45	54	120	90	14
NP 50	50	57	206	159	16
NP 50 EC	50	57	206	159	16
SNP 50 EC	50	57	135	101,6	16x2,00
UCP 210	50	57	206	159	16
UCPA 210	50	57	130	94	16
NP 55	55	64	219,5	171	16
NP 55 EC	55	64	219,5	171	16
SNP 55 EC	55	64	154	118	16x2,00
UCP 211	55	64	219	171	16
NP 60	60	70	241,3	184	16
NP 60 EC	60	70	241,3	184	16
SNP 60 EC	60	70	154	118	16x2,00
UCP 212	60	70	241	184	16
NP 65	65	69	241,3	193,7	16
UCP 213	65	76	265	203	20
NP 70	70	79	266	210	24
NP 75	75	83	275	217	24
NP 80	80	89	291	232	24
UCP 216	80	89	292	232	20
NP 85	85	95	310	247	24
UCP 217	85	95	310	247	20
NP 90	90	102	327	262	24
UCP 218	90	102	327	262	22

Lagerhus | Laakeripesät | Lejehuse

Stållagerhus i gjutjärn
Valurautapesät
Stålejhuse i støbejern

SNT74-75
 SNTD.....76

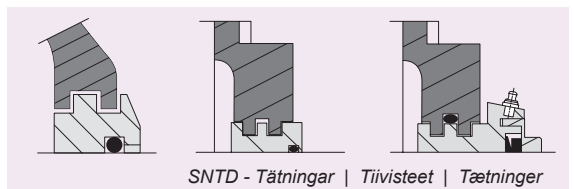
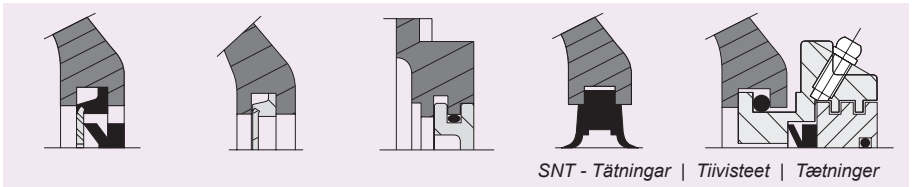
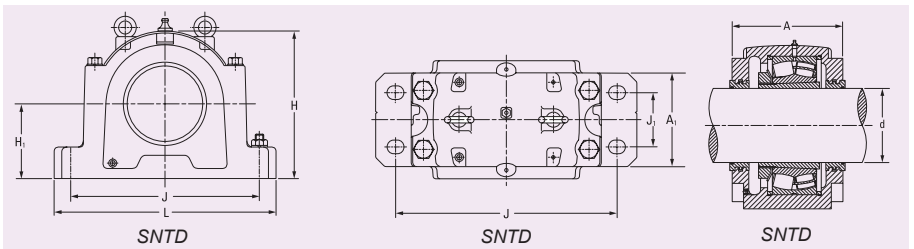
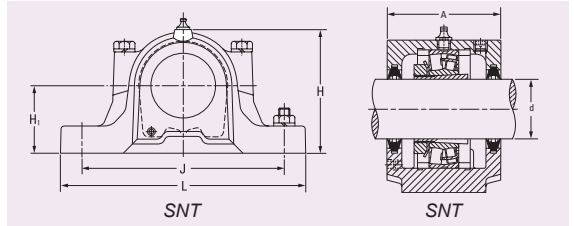

Lagerhus | Laakeripesät | Lejehuse

d 20-60 mm.

Hus nr Pesä nro Hus nr.	Axel Akseli Aksel Ø	Sfäriskt lager Pallomainen laakeri Sfærisk leje	Kläm- hylsa Kirstys- holkki Klem- bøsning	2-läpps- tätning Kaksoishuulitii- viste Dobbelt læbe-tætning	Styrring Nr Ohjainrenkaat Nro Styrering Nr.
SNT 505 SNT 506-605	20	22205K 21305K	H 305 H 305	TSNG 505 TSNG 605	SR 52x3,5 SR 62x7,5
SNT 506-605 SNT 507-606	25	22206K 21306K	H 306 H 306	TSNG 506 TSNG 606	SR 62x6 SR 72x7,5
SNT 507-606 SNT 508-607	30	22207K 21307K	H 307 H 307	TSNG 507-305 TSNG 607	SR 72x5,5 SR 80x9
SNT 508-607 SNT 510-608 SNT 510-608	35	22208K 21308K 22308K	H 308 H 308 H 2308	TSNG 508 TSNG 608 TSNG 608	SR 80x8 SR 90x9 SR 90x4
SNT 509 SNT 511-609 SNT 511-609	40	22209K 21309K 22309K	H 309 H 309 H 2309	TSNG 509 TSNG 609 TSNG 609	SR 85x3,5 SR 100x9,5 SR 100x4
SNT 510-608 SNT 512-610 SNT 512-610	45	22210K 21310K 22310K	H 310 H 310 H 2310	TSNG 510-307 TSNG 610 TSNG 610	SR 90x9 SR 110x10,5 SR 110x4
SNT 511-609 SNT 513-611 SNT 513-611	50	22211 K 21311 K 22311 K	H 311 H 311 H 2311	TSNG 511 TSNG 611 TSNG 611	SR 100x9,5 SR 120x11 SR 120x4
SNT 512-610 SNT 515-612 SNT 515-612	55	22212K 21312K 22312K	H 312 H 312 H 2312	TSNG 512 TSNG 612 TSNG 612	SR 110x10 SR 130x12,5 SR 130x5
SNT 513-611 SNT 516-613 SNT 516-613	60	22213K 21313K 22313K	H 313 H 313 H 2313	TSNG 513 TSNG 613 TSNG 613	SR 120x10 SR 140x12,5 SR 140x5

Lagerhus | Laakeripesät | Lejehuse

d 65-140 mm

Hus nr Pesä nro Hus nr.	Axel Akseli Aksel Ø	Sfäriskt lager Pallomainen laakeri Sfärisk leje	Kläm- hylsa Kiristys- holkki Klem bøsning	2-läpps- tätning Kaksoishuultii- viste Dobbelt læbetætning	Styrring Nr Ohjainrenkaat Nro Styrering Nr.
SNT 515-612 SNT 518-615 SNT 518-615	65	22215K 21315K 22315K	H 315 H 315 H 2315	TSNG 515 TSNG 615 TSNG 615	SR 130x12,5 SR 160x14 SR 160x5
SNT 516-613 SNT 519-616 SNT 519-616	70	22216K 21316K 22316K	H 316 H 316 H 2316	TSNG 516 TSNG 616 TSNG 616	SR 140x12,5 SR 170x14,5 SR 170x5
SNT 517 SNT 520-617 SNT 520-617	75	22217K 21317K 22317K	H 317 H 317 H 2317	TSNG 517 TSNG 617 TSNG 617	SR 150x12,5 SR 180x14,5 SR 180x5
SNT 518-615 SNT 518-615	80	22218K 23218K	H 318 H 2318	TSNG 518 TSNG 518	SR 160x12,5 SR 160x6,25
SNT 519-616 SNT 522-619 SNT 522-619	85	22219K 21319K 22319K	H 319 H 319 H 2319	TSNG 519 TSNG 619 TSNG 619	SR 170x12,5 SR 200x17,5 SR 200x6,5
SNT 520-617 SNT 520-617 SNT 524-620 SNT 524-620	90	22220K 23220K 21320K 22320K	H 320 H 2320 H 320 H 2320	TSNG 520 TSNG 520 TSNG 620 TSNG 620	SR 180x12 SR 180x4,85 SR 180x19,5 SR 215x6,5
SNT 522-619 SNT 522-619	100	22222K 23222K	H 322 H 2322	TSNG 522 TSNG 522	SR 200x13,5 SR 200x5,1
SNT 524-620 SNT 524-620	110	22224K 23224K	H 3124 H 2324	TSNG 524 TSNG 524	SR 215x14 SR 215x5
SNT 526 SNT 526	115	22226K 23226K	H 3126 H 2326	TSNG 526 TSNG 526	SR 230x13 SR 230x5
SNT 528 SNT 528	125	22228K 23228K	H 3128 H 2328	TSNG 528 TSNG 528	SR 250x15 SR 250x5
SNT 530 SNT 530	135	22230K 23230K	H 3130 H 2330	TSNG 530 TSNG 530	SR 270x16,5 SR 270x5
SNT 532 SNT 532	140	22232K 23232K	H 3132 H 2332	TSNG 532 TSNG 532	SR 290x17 SR 290x5

Lagerhus | Laakeripesät | Lejehuse

d 150-380 mm

Hus nr Pesä nro Hus nr.	Axel Akseli Aksel Ø	mm							Bult Pultti Bolt	Lager nr Laakeri nro Leje nr.	Hylsa Kolkki Bøsning	Vikt kg Paino kg Vægt Kg	Spärring Laakerilu- kiterengas Sporring nr/antal nro/määrä nr./antal
		H ¹	L	J	A ¹	H	A	J ¹					
SNTD 3134	150	170	510	430	180	333	230	100	24	23134K	H3134	75	SR 280x10
SNTD 3136	160	180	530	450	190	353	240	110	24	23136K	H3136	92	SR 300x10
SNTD 3138	170	190	560	480	210	375	260	120	24	23138K	H3138	112	SR 320x10
SNTD 3140	180	210	610	510	230	411	280	130	30	23140K	H3140	130	SR 340x10
SNTD 3144	200	220	640	540	240	434	290	140	30	23144K	OH3144H	140	SR 370x10
SNTD 3148	220	240	700	600	260	474	310	150	30	23148K	OH3148H	193	SR 400x10
SNTD 3152	240	260	770	650	280	516	320	160	36	23152K	OH3152H	235	SR 440x10
SNTD 3156	260	280	790	670	280	551	320	160	36	23156K	OH3156H	250	SR 460x10
SNTD 3160	280	300	830	710	310	591	350	190	36	23160K	OH3160H	310	SR 500x10
SNTD 3164	300	320	880	750	330	631	370	200	36	23164K	OH3164H	346	SR 540x10
SNTD 3168F¹	320	340	965	840	380	670	390	240	45	23168K	OH3168H	498	FIXED
SNTD 3172F¹	340	360	1040	890	390	720	390	255	50	23172K	OH3172H	532	FIXED
SNTD 3176F¹	360	380	1120	980	400	750	405	255	55	23176K	OH3176H	590	FIXED
SNTD 3180F¹	380	400	1245	1050	420	790	405	270	60	23180K	OH3180H	663	FIXED

¹Fast hus, även tillgängligt i L-version, flytande hus

¹Sama pesä saatavana sekä kiinteänä F-versiona että uivana L-versiona

¹Fikseret hus, fås også som L-version, flydende hus

FLÄNSLAGERHUS LAAKERIPESÄT FLANGELEJHUSE

Flänslagerhus	77-78
Laakeripesät	77-78
Flangelejhuse	77-78

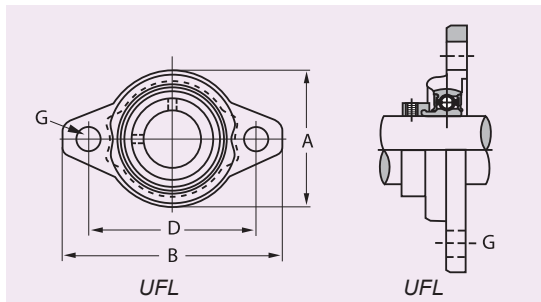
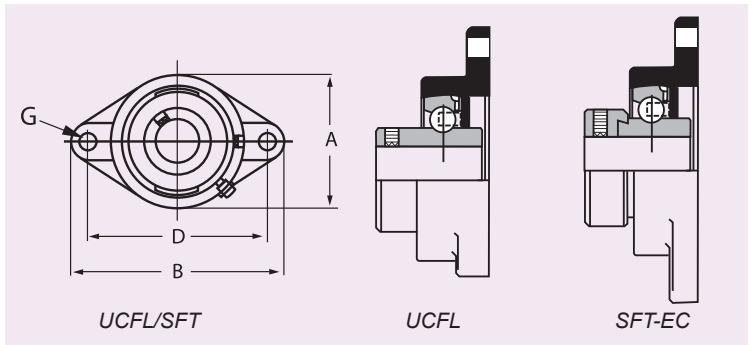
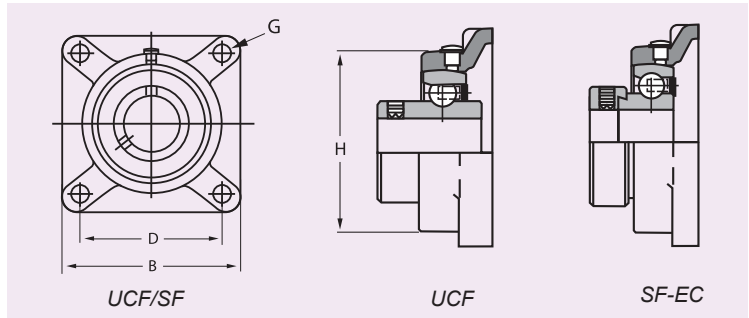

Flänslagerhus | Laakeripesät | Flangelejhuse

d 8-90 mm.

Beteckning Nimike Betegnelse	mm			Skruv Ruuvi Skruue	
	d	H	B	D	G
	SF 12 EC	12	52,5	76,2	54
UCF 201	12		86	64	10
SF 15 EC	15	52,5	76,2	54	M10
UCF 202	15		86	64	10
SF 17 EC	17	52,5	76,2	54	M10
UCF 203	17		86	64	10
SF 20 EC	20	60,3	85,7	63,5	M10
UCF 204	20		86	64	10
SF 25 EC	25	68	95,3	70	M10
UCF 205	25		95	70	10
SF 30 EC	30	68	95,3	70	M10
UCF 206	30		108	83	10
SF 35 EC	35	95,3	117,5	92	M12
UCF 207	35		117	92	12
SF 40 EC	40	101,6	130,2	101,5	M12
UCF 208	40		130	102	14
SF 45 EC	45	111,1	136,5	105	M16
UCF 209	45		137	105	14
SF 50 EC	50	115,9	142,9	111	M16
UCF 210	50		143	111	14
SF 55 DEC	55	127	161,9	130	M16
UCF 211	55		162	130	16
SF 60 DEC	60	138,1	174,5	143	M16
UCF 212	60		175	143	16
SF 65 DEC	65	155,5	187,5	149,22	M16
UCF 213	65		187	149	16
SF 70 DEC	70	155,5	187,5	149,22	M16
UCF 214	70		193	152	16
SF 75 DEC	75	158,5	196,5	152,4	M20
UCF 215	75		200	159	16
UCF 216	80		208	165	20
UCF 217	85		220	175	20
UCF 218	90		235	187	20

Beteckning Nimike Betegnelse	mm			Skruv Ruuvi Skruue	
	d	A	B	D	G
	UFL08	8	27	48	37
UFL000	10	36	60	45	M6
UFL001	12	38	63	48	M6
SFT 12 EC	12	52,5	99	76,5	M10
UCFL 201	12	60	113	90	M10
UFL002	15	42	67	53	M6
SFT 15 EC	15	52,5	99	76,5	M10
UCFL 202	15	60	113	90	M10
UFL003	17	46	71	56	M6
SFT 17 EC	17	52,5	99	76,5	M10
UCFL 203	17	60	113	90	M10
UFL004	20	55	90	71	M8
LFTC20	20	71,0	91	76,0	M8
SFT 20 EC	20	60,0	112	90,0	M10
UCFL 204	20	60	113	90	M10
UFL005	25	60	95	75	M8
LFTC25	25	71,0	96	76,0	M8
SFT 25 EC	25	68,0	124	99,0	M10
UCFL 205	25	68	130	99	M14
UFL006	30	70	112	85	M10
SFT 30 EC	30	82,6	141	116,5	M10
UCFL 206	30	80	148	117	M14
SFT 35 EC	35	95,5	156	130,0	M12
UCFL 207	35	90	161	130	M14
SFT 40 EC	40	101,6	171	143,5	M12
UCFL 208	40	100	175	144	M14
SFT 45 EC	45	111,1	179	148,5	M16
UCFL 209	45	108	188	148	M16
SFT 50 EC	50	115,9	189	157,0	M16
UCFL 210	50	115	197	157	M16
SFT 55 EC	55	127,0	216	184,0	M16
UCFL 211	55	130	224	184	M16
SFT 60 EC	60	138,1	235	202,0	M16
UCFL 212	60	140	250	202	M20
UCFL 213	65	155	258	210	M20
UCFL 214	70	160	265	216	M20
UCFL 215	75	165	275	225	M20
UCFL 216	80	180	290	233	M22
UCFL 217	85	190	305	248	M22
UCFL 218	90	205	320	265	M22

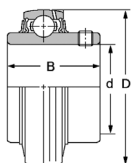

UC

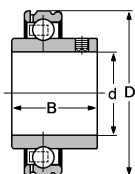

1000G

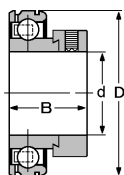

1200ECG

Beteckning Nimike Betegnelse	d	mm D	B
1017-12 G	12	40	27,4
1217-12 ECG	12	40	28,6
UC 201	12	47	31
1017-15 G	15	40	27,4
1217-15 ECG	15	40	28,6
UC 202	15	47	31
1017-16 G	16	40	27,4
1217-16 ECG	16	40	28,6
1017-17 G	17	40	27,4
1217-17 ECG	17	40	28,6
UC 203	17	47	31
1020-20 G	20	47	31
1220-20 ECG	20	47	31
UC 204	20	47	31
1025-25 G	25	52	34,1
1225-25 ECG	25	52	31
UC 205	25	52	34
1030-30 G	30	62	38,1
1230-30 ECG	30	62	35,7
UC 206	30	62	38,1
1035-35 G	35	72	42,9
1235-35 ECG	35	72	38,9
UC 207	35	72	42,9
1040-40 G	40	80	49,2
1240-40 ECG	40	80	43,6
UC 208	40	80	49,2
1045-45 G	45	85	49,2
1245-45 ECG	45	85	43,6
UC 209	45	85	49,2
1050-50 G	50	90	51,6
1250-50 ECG	50	90	43,6
UC 210	50	90	51,6
1055-55 G	55	100	55,6
UC 211	55	100	55,6
1060-60 G	60	110	65,1
UC 212	60	110	65,1
1065-65 G	65	120	65,1
UC 213	65	120	65,1
1070-70 G	70	125	74,6
UC 214	70	125	74,6
1075-75 G	75	130	77,8
UC 215	75	130	77,8
1080-80 G	80	140	82,6
UC 216	80	140	82,6
1085-85 G	85	150	85,7
UC 217	85	150	85,7
1090-90 G	90	160	96
UC 218	90	160	96
3095-95 G	95	200	117,5
3095-100 G	100	200	117,5